

SECTION A-A
SCALE (1:50)

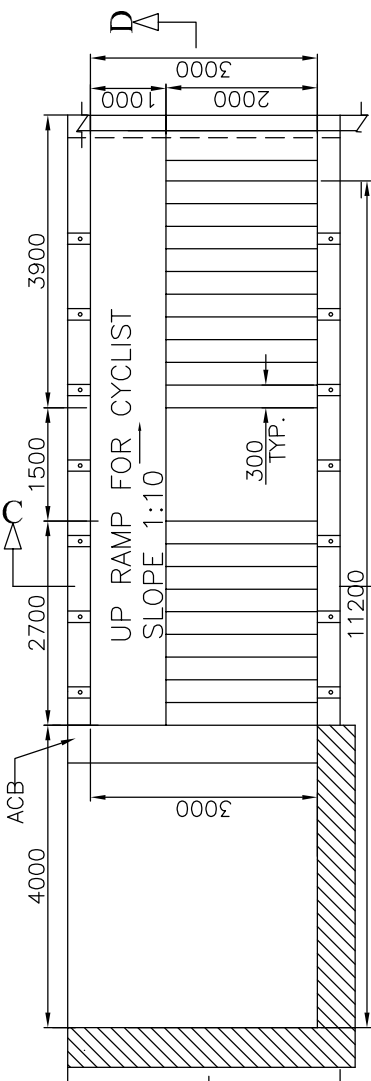

PLAN SHOWING FOR DETAILS OF STAIR CASE
(SCALE 1:100)

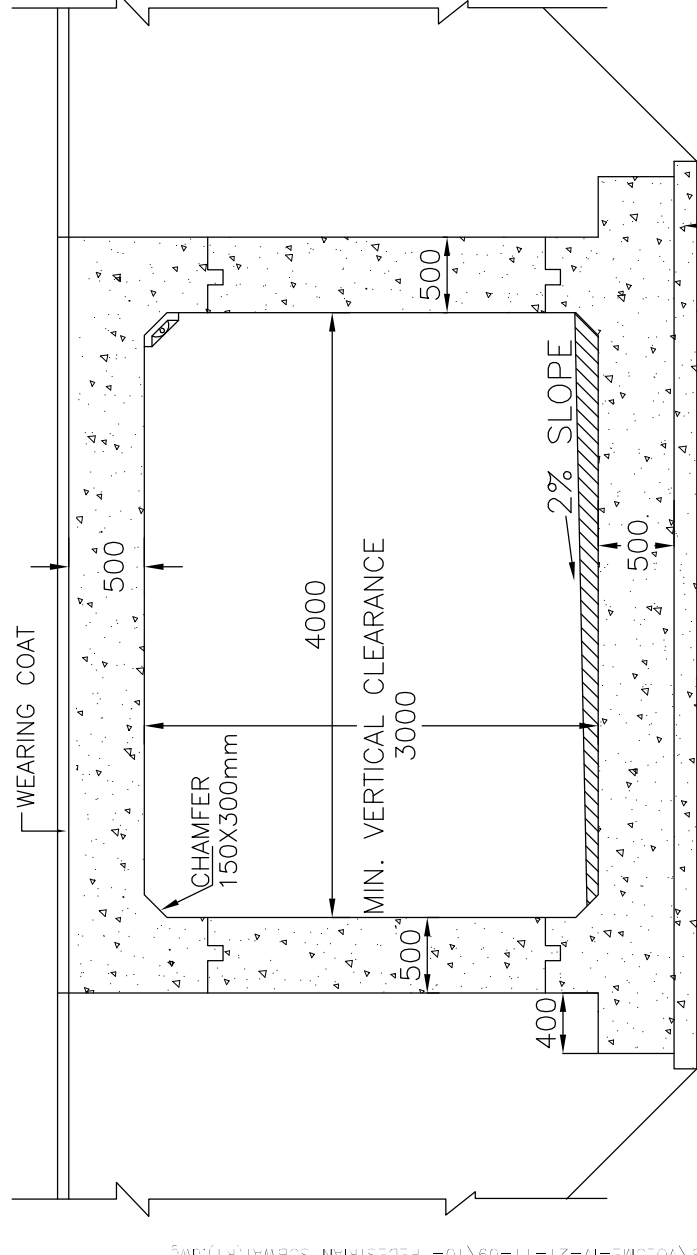

SECTION C-C

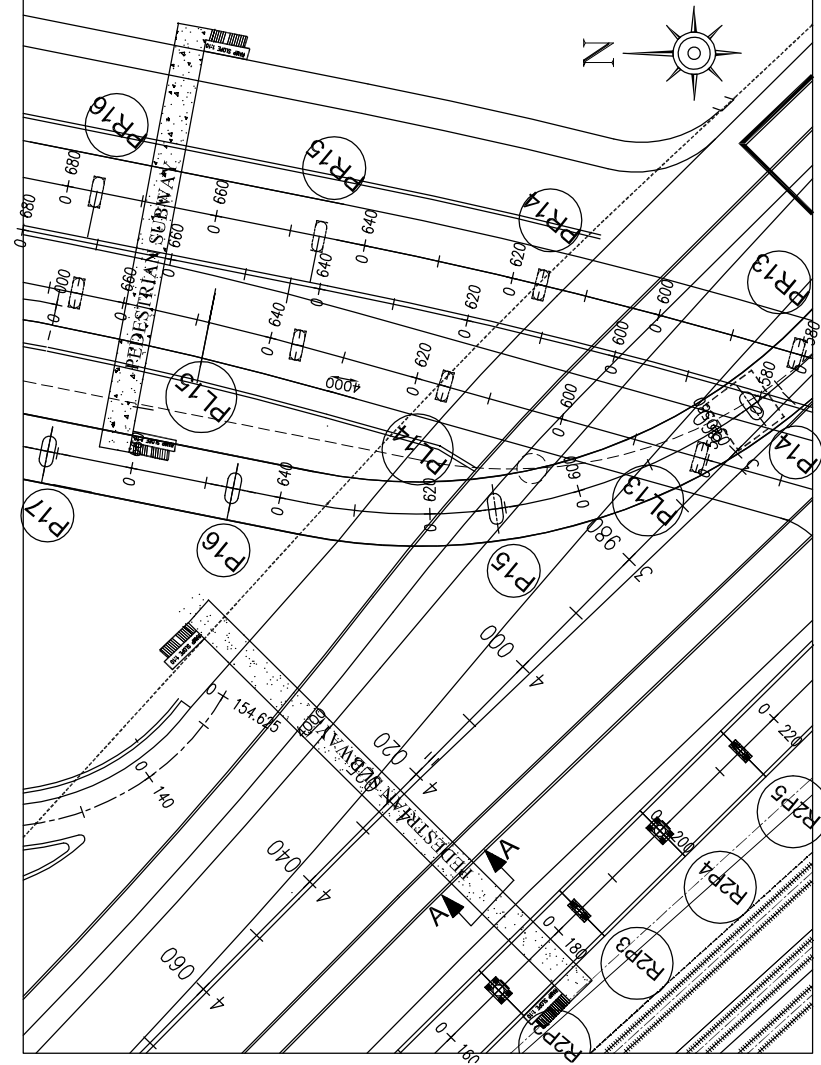

REFERENCE DRAWINGS (REFER LATEST REVISION):-

1. ALIGNMENT PLAN DRAWING -- DRG.NO.2005191/ALIGNMENT PLAN-001.
2. GENERAL NOTES --- DRG.NO.2005191/NOTES-07.

- NOTES:
1. ALL DIMENSIONS ARE IN MILLIMETERS UNLESS OTHERWISE MENTIONED. ONLY WRITTEN DIMENSIONS ARE TO BE FOLLOWED.
 2. SOIL DENSITY ON THE BACKFILL AND EARTH CUSHION SHOULD CONFIRM TO CLAUSE 305.2.1.5 OF MOST SPECIFICATION.
 3. SAFE BEARING CAPACITY REQUIRED SHALL BE 15 T/SQM.
 4. FOUNDING LEVEL IS TOP OF LEVELING COURSE. ALL UNDULATIONS IN THE EXCAVATED ROCK LEVEL SHALL BE MADE UP WITH PCC M10 TO GIVE AVERAGE 150MM THICKNESS.
 5. USE M-25 GRADE CONCRETE & H.Y.S.D. S-415 CONFIRMING TO IS:1786-1979 FOR ALL COMPONENTS OF BOX.
 6. 100 DIA WEEP HOLES @ 1000 C/C STAGGERED VERTICALLY & 1000 C/HORIZONTALLY IS TO BE PROVIDED IN VERTICAL WALLS.
 7. GRANULAR BACKFILL (INVERTED FILTER) OF 600MM WIDTH ON THE EARTH FACE OF BOX SHALL BE PROVIDED FOR DRAINAGE OF SATURATED BACKFILL.

CITY ENGINEER
PIMPRI CHINCHWAD MUNICIPAL CORPORATION
PIMPRI, PUNE - 411 018.

EXECUTIVE ENGINEER (PROJECTS)
PIMPRI CHINCHWAD MUNICIPAL CORPORATION
PIMPRI, PUNE - 411 018.

DRG. NO. 2005191/SUBWAY/CH.4+025 -010	REVISION NO. RO	DATE: 10-07-07	PURPOSE FOR TENDER
	DESIGN(B)	CHECKED (C)	APPROVED (D)
	D.V. WALI	D.B. JOTAWAR	M.K. GANGLI
	RUPALI CHAVAN	N.A. SURYAWANSHI	

TITLE:
GENERAL ARRANGEMENT DRAWING
FOR PROPOSED PEDESTRIAN
SUBWAY

NAME OF WORK:
DESIGN AND CONSTRUCTION OF FLYOVER AND
ROB AT NASHIK PHATA ON OLD MUMBAI PUNE
NH-4 INCLUDING BRIDGE ON RIVER PAWANA.

CLIENT:- PIMPRI CHINCHWAD MUNICIPAL CORPORATION
PIMPRI
PUNE - 411 018.
PH.: +91 -20-27425511 FAX: +91 -20-27425600
E-mail: pcmc@vsnl.com Web: www.pcmc.org

CONSULTANT:- CONSULTING ENGINEERING SERVICES (I) PVT LTD
41-A, MAKER TOWER, 'E', CUFFEE PARADE, MUMBAI-400 005.
Web: www.cesinter.com
E-mail: cesmb@vsnl.com
PUNE OFFICE: TELEFAX: 020-25434626 e-mail: cespune@vsnl.com
MUMBAI PUNE NEW DELHI

REV	DATE	DESCRIPTION OF REVISION	A	B	C	INITIALS
R-1	21.11.08	MODIFIED AS PER BRTS COMPLIANCE				
R-2	22.09.08	MODIFIED AS PER BRTS COMPLIANCE				
R-3	24.12.07	MODIFIED AS PER CHANGES SUGGESTED BY RLVS AND NHAI				
R-4	17.10.07	MODIFIED AS PER CHANGES SUGGESTED BY RLVS AND NHAI				
R-5	09.08.07	FOR TENDER PURPOSE				